

# ET300AU

## Instruction Manual

### Digital Circuit Breaker Finder

- FULLY AUTOMATIC
- FLASHING ARROW INDICATOR FOR EASY IDENTIFICATION
- 90 – 280V AC OPERATION
- MICROPROCESSOR CONTROLLED FOR MORE ACCURATE READINGS

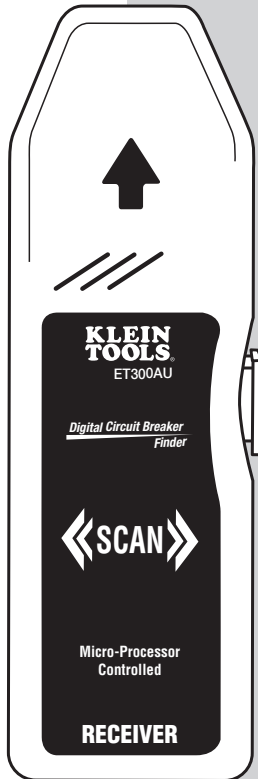
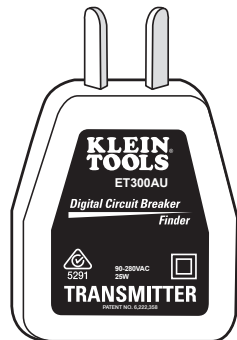

For Professionals... Since 1857™



5291

ENGLISH

## ET300AU Instruction Manual

### GENERAL SPECIFICATIONS

- Operating Voltage: 90 – 280V AC, 25W
- Operating Frequency: 50 – 60Hz
- Tracking Distance: Up to 305 m (1,000 ft.)
- Operating Temperature: 0°C to 40°C (32°F to 104°F)
- Relative Humidity: 50%
- Altitude: < 2,000 m (6,562 ft.)
- Environment: For indoor use only
- Power: 9 volt alkaline battery
- Auto Power Off: Approximately 4 minutes
- Transmitter Dimensions: 71 x 48 x 30 mm (3" x 2" x 1")
- Receiver Dimensions: 152 x 51 x 23 mm (6" x 2" x 1")
- Transmitter Weight: 45 g (1.6 oz.)
- Receiver Weight: 91 g (3.2 oz.)
- Sensitivity: Indication at 4 mm (0.16") distance from a wire carrying 250V AC.
- Safety Rating: AUSTRALIA RCM 5291 (Regulatory Compliance Mark)
- Insulation: Double

### SAFETY PRECAUTIONS

To ensure safe operation and service of the tester, follow these instructions. Failure to observe these warnings can result in severe injury or death.

- Understand the risks of working around live voltage.
- Turn off power before inspecting, applying, or removing the transmitter.
- Exercise extreme caution around live, bare wires, especially in an open breaker panel.
- Consult with an experienced electrician when necessary.

### INSTRUCTIONS

1. Identify the wall outlet or fixture for which the breaker must be determined.
2. Safely check that the outlet or fixture is live.
3. Plug in the transmitter. Its LED will light if it is receiving power (see illustration 1).
4. Move to the breaker panel with the receiver.
5. Turn on the receiver by pressing, but not holding, the power button. You will hear a beep and see its LED lit (see illustration 2).
6. Position the receiver **perpendicular** to the breakers in the panel to be scanned (see illustrations 3 & 4).
7. Slowly scan all breakers in the panel once by moving the receiver side to side along the breaker panel (see illustrations 3 & 4). Ignore any beeps or indications, as the receiver is learning the panel.
8. Scan all breakers a second time. This time, the receiver will beep and illuminate the green arrow only at the correct breaker.
9. Power off the receiver by pressing and holding the power button. Return to the outlet or fixture and remove the transmitter.

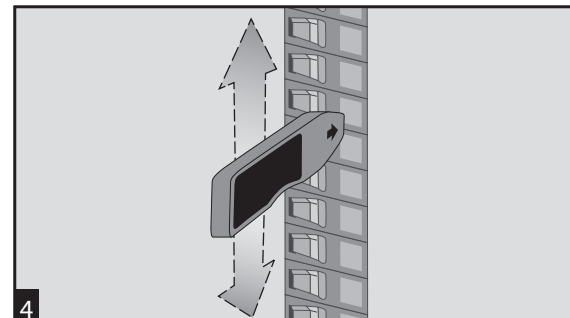
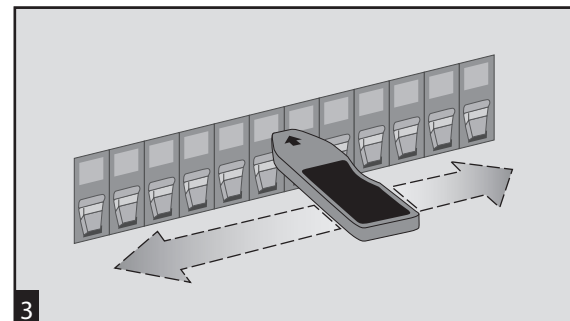
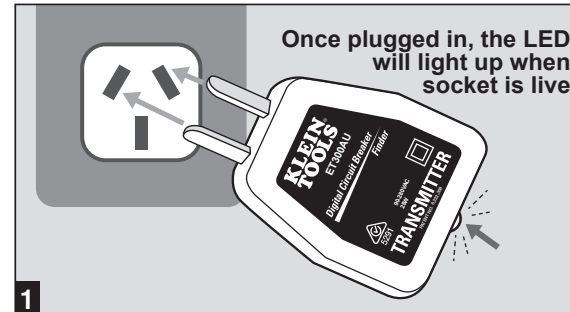

### WARRANTY

[www.kleintools.com/warranty](http://www.kleintools.com/warranty)

### CLEANING

Clean the instrument by using a damp cloth. Do not use abrasive cleaners or solvents.

### STORAGE

Remove the batteries when instrument is not in use for a prolonged period of time. Do not expose to high temperatures or humidity. After a period of storage in extreme conditions exceeding the limits mentioned in the Specifications section, allow the instrument to return to normal operating conditions before using it.

### DISPOSAL / RECYCLE



Do not place equipment and its accessories in the trash. Items must be properly disposed of in accordance with local regulations.

### CUSTOMER SERVICE

**KLEIN TOOLS**  
25 Aldershot Road  
Lonsdale, SA 5160

1300 55 77 77  
[www.kleintoolsaustralia.com](http://www.kleintoolsaustralia.com)